

ASSEMBLING INSTRUCTIONS

*use only socket E-12/E14 and small bulb.

WE RECOMMEND 4 W ENERGY EFFICIENT LED BULB

STEP 1

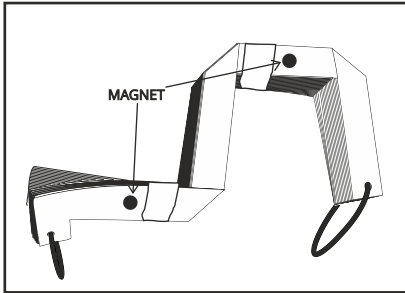

OPEN THE LAMP BY REMOVING THE PAPER STRAP

STEP 2

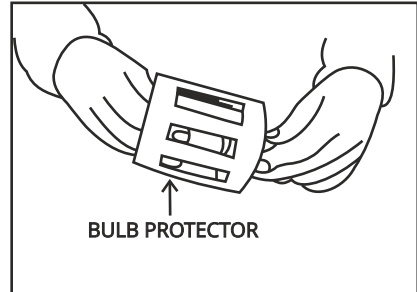

TAKE THE BULB PROTECTOR AND SETTLE BULB SOCKET WITH ELECTRICAL WIRE IN

STEP 3

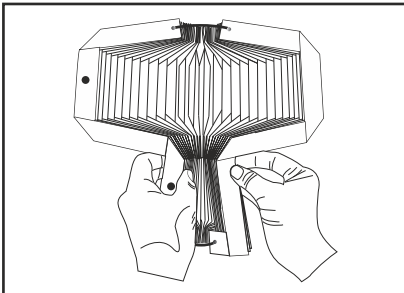

PUT THE WIRE IN THE CENTER OF THE RING AFTER OPENING IT THEN CLOSE THE RING ONCE THE WIRE IS INSERTED.

STEP 4

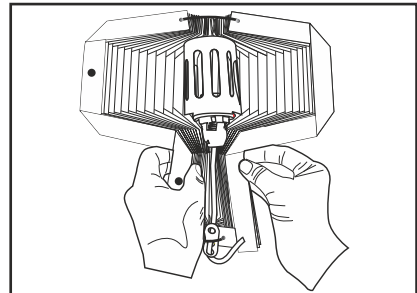

FIX THE SOCKET IN THE CENTER OF THE SHADE BY PLACING THE HOOK ON ELECTRICAL WIRE .

STEP 5

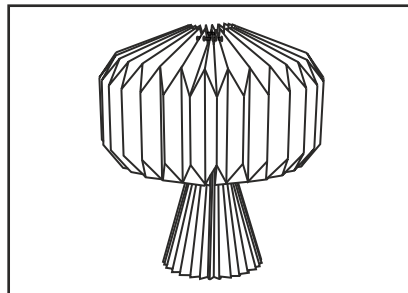

THE LAMP IS READY TO USE ONCE THE LAMP SHADE IS CLOSED.